



PANDAW: RIVERS, DATES AND RATES



MEKONG EXPLORATION FROM VIETNAM TO CAMBODIA

There can be no tapestry of river life as fascinating and varied as the River Mekong. Indeed there can be no more striking a cultural contrast as that between the bustling Vietnam delta and the tranquility of Cambodia. We pass from the vibrant French colonial port of Saigon, now called Ho Chi Minh City, through the vast delta so rich in human life and endeavour, to travel along the main channel into the rich countryside of Cambodia.

A shipping link between Ho Chi Minh and Angkor is immensely practical for the traveller. It makes it possible to connect three important destinations on one trip with easy plane connections at either end: Saigon the exotic Frenchified former capital of South Vietnam, Phnom Penh, the quaint Cambodian capital, and the stupendous World Heritage monuments at Angkor. You need no longer check in and out of hotels and endure bumpy roads to visit these magnificent places.

The *RV Mekong Pandaw* sails every Saturday from June to April. Per person price for main deck cabin sharing are from US\$1,415 in low season and from US\$2,205 in high season.

Sailing Dates from June 2011

18 June, 25 June, 2 July, 9 July, 23 July, 30 Jul, 6 Aug, 13 Aug, 20 Aug, 27 Aug, 3 Sep, 10 Sep, 17 Sep, 24 Sep, 1 Oct, 8 Oct, 15 Oct, 22 Oct, 29 Oct, 5 Nov, 12 Nov, 19 Nov, 26 Nov, 3 Dec, 10 Dec, 17 Dec, 24 Dec, 31 Dec

Sailing Dates for all 2012

7 Jan, 14 Jan, 21 Jan, 28 Jan, 4 Feb, 11 Feb, 18 Feb, 25 Feb, 3 Mar, 10 Mar, 17 Mar, 24 Mar, 2 Jun, 9 Jun, 16 Jun, 23 Jun, 30 Jun, 7 Jul, 14 Jul, 21 Jul, 28 Jul, 4 Aug, 11 Aug, 18 Aug, 25 Aug, 1 Sep, 8 Sep, 15 Sep, 22 Sep, 29 Sep, 6 Oct, 13 Oct, 20 Oct, 27 Oct, 3 Nov, 10 Nov, 17 Nov, 24 Nov, 1 Dec, 8 Dec, 15 Dec, 22 Dec, 29 Dec



RV MEKONG PANDAW

Upstream Cruises from Ho Chi Minh to Siem Reap or Vice Versa - Eight Days

Day 1: Ho Chi Minh / My Tho / Cai Be

Transfer from our designated rendezvous point in Ho Chi Minh to the port of My Tho by coach for embarkation.

Day 2: Cai Be / Sa Dec / Cu Lao Gien

In the morning passengers will take an exciting Sampan boat excursion to Sa Dec via Vinh Long, along canals and backwaters. Passengers will visit Cai Be and its colourful floating market and Sa Dec to see the local market and the ancient house of Mr. Huyn Thuy Le, the 'lover' of Marguerite Duras, a famous French novelist. In the afternoon, we visit Cu Lao Gien island and a Catholic monastery called 'La Providence'.

Day 3: Chau Doc / Border Crossing

Visit a Cham tribal village, a cat fish farm, and enjoy a trishaw ride round Chau Doc. Return to the ship by boat for lunch and cast off for the Cambodian border for the usual formalities.

Day 4: Phnom Penh

Passengers will visit Phnom Penh and will be provided with their own private cyclo*. The Cyclo Centre Phnom Penh which provides the cyclos is a charity that provides basic welfare and medical services to cyclo drivers (www.cyclo.org.uk). *In the afternoon, optional excursion (by coach) to the Killing Fields and the Khmer Rouge's grim Tuol Sleng or S21 detention centre. This tour is included in the cost of your cruise but must be requested at the time of booking.*

Day 5: Tonle River / Kampong Chhnang

Excursion up the Tonle River to Kampong Chhnang either by ship or by coach depending on water levels. In Kampong Chhnang passengers will take a wonderful motor boat excursion into the lakeside wetlands that form the mouth of the river. Here many fishtraps may be seen.

Day 6: Kampong Cham / Mekong River

We stop at the little-known Chong Koh silk-weaving village for a morning walk at leisure. In the afternoon we stop at Peam Chi Kang village to visit the wat or monastery and school. In the wat the splendid village racing boats are stored.

Day 7: Kampong Cham Area

Passengers visit the hilltop temple of Wat Hanchey in the morning. In the afternoon, travel by bus to visit the Twin Holy mountains of Phnom Pros and Phnom Srey (Man and Woman Hill). Continuation to the ecotourism village of Choengkok supported by the French-Cambodian NGO Amica and the Pandaw-supported Kampong Cham orphanage.

Day 8: Transfer to Siem Reap

Early morning coach transfer to our partner the *Raffles Grand Hotel D'Angkor* in Siem Reap. Refreshments will be provided and we will stop at Kampong Thom along the way. Arrive at Siem Reap mid afternoon.

BURMA: LAND OF GREAT RIVERS

We began in Burma. The unique Pandaw river expedition concept evolved here from the vestiges of the colonial Irrawaddy Flotilla Company. Our ships were built here and in Burma we learnt to master river navigation at its worst. These lessons were applied to the other rivers of Asia.

Burma, after 1987 renamed by the regime Myanmar, is the largest mainland South-East Asian country and with the greatest variety of scenery from Himalayan peaks to tropical beaches. We have yet to meet a visitor to Burma who does not feel that this is the most beautiful, friendly and culturally interesting Asian country ever visited.

Most of the population live in three great river valleys encircled by impenetrable horseshoes of mountains. River life dominates the country and still to this day forms the main system of transportation, irrigation and from its rich fishing grounds the principal protein source for the majority of the population.

In the great Chindwin, Irrawaddy and Salween valleys two millennia of Buddhist art, architecture and archaeology survive, including of course the 3000 standing monuments at Pagan. There is no other Asian country with so vast and varied a range of cultural sites. Almost everywhere there are temples and monasteries, festivals and ceremonies. The Burmese are a deeply pious people and Buddhist activities dominate every aspect of life.

The Burmese are a very warm and hospitable people who since Independence in 1947 have suffered terrible impoverishment and deprivation. We do our best to support the local domestic economy and make sure our suppliers and contractors are small local businesses. We are very careful to make sure our clients' money falls into the right hands.

Our Pandaw passengers believe that by visiting Burma we are doing something to help as has been proved by the many schools our passengers have built, not to mention the outstanding contribution made by our passengers after Cyclone Nargis struck in 2008. These cruises are the most acclaimed luxury vacations on the Irrawaddy river.

Only six departures a year on the *Pandaw II*, our smallest ship. Sails between October and March. Per person price for main deck cabin sharing are from US\$4,050.

Sailing Dates 2011
4 Oct, 1 Nov, 23 Dec

Sailing Dates 2012
1 Feb, 1 Mar, 5 Oct, 1 Nov, 23 Dec



RV PANDAW II - THE IRRAWADDY

Upstream 14 Nights 600 miles and see all Burma

Day 1: Prome and the Ancient Pyu

Meet at the Chatrium Hotel in Yangon and transfer by coach to Prome. Visit the 5th-8th century archaeological site of Thiri-ya-kittiya, former centre of the Pyu civilization. We cross jungle and countryside to visit monumental Pyu stupas and the excavations of the former palace-city in this walled early centre of Buddhism.

Day 2: Thayetmyo Frontier Post

This pleasant colonial town once guarded the border between Royal Burmah and British Burmah following the 2nd Anglo Burmese War of 1855 and many of the buildings including the covered market date from this period. We visit the market, see the colonial houses and ride out by horse and cart to see the countryside and golf links.

Day 3: Minhla Forts and Magwe

In Minhla and Gwechaung we visit the two Italian built forts constructed to keep the British at bay from Royal Burmah. We climb the Gwechaungzhill for the view. In the afternoon we cruise on to Magwe where we climb the river bank and wend our way through a labyrinth of passages and paths to reach the magnificent Myat-thalon Pagoda.

Day 4: Sale Monasteries

Here we visit a number of teak monasteries including the Yout-saun-kyauing with its spectacular wood carvings; we also explore an area of splendid colonial-style houses.

Day 5: Pagan

In the morning, moor at the Tan-Chi-Taung mountain and ascend by WWII jeep. Afternoon, we tour a selection of the 3,000 listed monuments at this World Heritage Site, Pagan.

Day 6: Pagan Monuments

Further exploration by coach of the monuments follow by a lacquerware workshop and visiting the local markets. Sail in the noon to upstream and evening walk in Oh Ne Kyaung village to see the local life in this typical river side community.

Day 7: Yandabo

This very small rural village specialises in pot making. We visit the Pandaw School, built with past donations from Pandaw passengers.

Day 8: Mandalay and Amarapura

Passenger will take a tour of central Mandalay visiting the Mahamuni Pagoda and Shwe Nan Daw Kyaung teak carved monastery. Next we explore the ancient capital of Amarapura by coach and sampan and crossing the U Bein Bridge to see the paintings in a temple.

Day 9: Mingun Pagoda and Bell

We stop at Mingun to see the largest working bell in the world and the unfinished pagoda, that is the largest single mass of brick building in the world. We also visit the Mingun Old Peoples Home originally established with the assistance of the Irrawaddy Flotilla Company in the 1930s.

Day 10: Kyaung-myong Potteries and Khan-nyat Village

Visit the spectacular potteries near Kyauk-myong where the famous 50 gallon water pots are hand made. We see all stages of manufacture from the throwing of the pots to the week long firing in huge kilns. We enter the Third Defile and sail upstream all day stopping at Khan-nyat village with its many Buddhist monasteries and an orphanage we support.

Day 11: Tagaung Ancient City and Tigyang Hill

We explore by foot the ancient city of Tagaung viewing the fortifications, the shrine of Bo Bo Gyi a famous nat or spirit who protects sailors plying the river, and the archaeological area. In the evening we climb the Pagoda Hill at Tigyang with its stunning views of the Irrawaddy.

Day 12: Katha / Burmese Days

We reach the enchanting colonial town of Katha, setting for George Orwell's *Burmese Days*, and little changed since then. Of interest is the fire station's collection of IFC ships bells taken from sunken ships in the Second War.

Day 13: Shwegu and the Second Defile

Travel by local speedboat to view this the largest of the three Irrawaddy gorges.

Day 14: Downstream

We stop for a walk in a jungle village.

Day 15: Mandalay

Disembark in afternoon.

INTO THE HEART OF BORNEO

Borneo, the third largest island in the world after Greenland and Australia, has one of the most diverse eco systems on the planet, its primary rain forest home to a vast number of species of flora and fauna.

Now part of Eastern Malaysia, Sarawak was ruled for exactly one hundred years by the Brooke family, known as the Raja Brookes, and only joined the British Empire after the war, gaining independence in 1966.

The Rajang River, at 640km is the longest river in Malaysia, flows across Borneo from Sarawak into Indonesian Kalimantan. Though well known to many from Redmon O'Hanlon's classic *Into the Heart of Borneo*, there is very little tourism here due to the river's remoteness and lack of facilities. The scenery is magnificent – a total jungle experience with the rainforest tumbling into the fast flowing river.

The Rajang is navigable on a ship of Pandaw's size for at least 250km until the Pelagus Rapids, and further on its main tributary the Baleh River. The river is peopled with the Iban, headhunters till the 1950s, whose unique long house culture survives well to this day, blending well animist tradition with modernity.

There is much to do and see upriver, whether just gazing at the amazing scenery or visiting long houses. In these river towns we can explore the architectural vestiges of the Brooke Raj. Jungle treks, for all levels, are a must as are long boat trips to the Pelagus rapids.

Downriver, the prosperous Chinese city of Sibul with its old shop houses, markets and friendly inhabitants, is a calm reflection of an old China that probably no longer exists in mainland China. Sibul with its rich surrounding farmlands and tropical climate is an important agricultural area.

Further downstream, is Sarikei, the biggest producer of pepper in Sarawak. Passengers visit pepper farms and fruit plantations that host pineapples and other exotic fruits. The sea port of Tanjung Manis is a centre of traditional songket textile production and we will visit weaving workshops.

The most delightful city in South-East Asia, Kuching offers a glimpse of what Singapore or Bangkok must have been like half a century ago. Laid back, yet full of cafés and bars, the traditional Chinese shop houses as yet untrammelled by developers. The serene Sarawak River flows through the city centre, flanked by gorgeous Brooke Raj palaces, courts and a glistening white fort that marks the first White Raja's landing.

The *RV Orient Pandaw* sails year round with main deck cabins from US\$2,247 per person sharing for eight nights and nine days.

Sailing Dates from Apr 2011

1 Apr, 10 Apr, 20 Apr, 1 May, 10 May, 20 May 20 Jun, 1 Jul, 20 Jul, 1 Aug, 1 Sep, 1 Oct, 10 Oct, 20 Oct, 1 Nov, 10 Nov, 20 Nov, 10 Dec, 20 Dec

Sailing Dates from Jan 2012 to Mar 2012

1 Jan, 10 Jan, 20 Jan, 1 Feb, 10 Feb, 20 Feb, 1 Mar, 10 Mar, 20 Mar



RV ORIENT PANDAW

8-Night roundtrip cruise from Sibul

Day 1: Sibul / Durin

Transfer from the airport to the ship moored at the Burung Apu Warf next to the Express Boat Terminal. Cast off in the evening cruising upstream towards the Durin Bridge.

Day 2: Kanowit River

Cruise up the Rajang River to Kanowit where, water levels permitting, we will enter the Kanowit River and cruise deep into the jungle. Return to the Rajang continue upstream until sunset.

Day 3: Kapit

Early morning sail to within sight of Kapit. Passengers are transferred to shore by Shuttle Boat and enjoy a guided walk through the bustling market at height of morning activity followed by a visit to Fort Sylvia and Kapit Museum. Return to ship for lunch. After lunch we travel back into Kapit on the shuttle boat and transfer to van and drive out to town to a traditional longhouse where we witness the ceremonial miring (welcoming) ceremony. Passenger return to ship for dinner with a local twist.

Day 4: Pelagus Rapids

We experience a jungle trek in the cool of the morning along a specially prepared trail through strands of primary and secondary forest. There are two bridges over a jungle creek with small waterfalls. Active walkers should be able to complete the whole loop of the trail. Less active walkers are encouraged to climb up the first ridge to the second rest area and return. During lunch we will move the ship to the Rajang/Baleh confluence and await an excursion boat for the afternoon sail up to the famous Pelagus Rapids. Here, the ship anchors overnight near the Baleh Junction.

Day 5: Baleh River

We will travel by open expressboat up the Baleh River "Into the heart of Borneo". Our first stop is at Mujong village where we visit the local school (unless holiday or weekend) and meet the children and teachers. We then travel to the Palawan area and enjoy a picnic lunch of bamboo cooking on a tranquil shaded beach. After lunch we sail to Song. Onboard entertainment in Song is a traditional dance evening after dinner presented by students of the local school and residents.

Day 6: Song to Rajang Village

We enjoy an early morning, before breakfast, excursion on long boats. We sail up two small creeks opposite Song to witness the local travelling market and possibility of some bird watching. After breakfast, we sail all day downriver to reach the mouth and sea at Rajang village by sunset.

Day 7: Rajang Village to Sarikei

We will take a morning stroll through this delightful Melanau Village which has a far different culture to the upriver towns. We then sail back upriver to Sarikei. The afternoon is free to wander around Sarikei and appreciate the sea air.

Day 8: Sarikei to Sibul

We visit Nyuka longhouse from Sarikei travelling by van for a pleasant morning walk through pastoral fields to visit scenic waterfall and return for refreshments, and other activities in the longhouse and grounds. Non walkers depart after breakfast to same longhouse and visit a pepper garden on the way. Upon return to the ship, we sail for Sibul.

Day 9: Sibul

All day disembarkation in Sibul. Passengers can disembark from 8am on the last day of the cruise.

FEATURES OF A PANDAW RIVER CRUISE

INCLUDED IN YOUR PANDAW CRUISE

- Welcome cocktail party
- Signature hors d'oeuvres at cocktails each evening
- Afternoon tea with cakes or cookies when cruising
- Celebration cake and champagne on birthdays and anniversaries
- Cookery demonstrations and classes using local produce
- All scheduled excursions
- At least two cultural performances per cruise
- Tour of the engine rooms, galley and working parts of the ship
- Film presentations on local culture and history
- Sodas, beers, local spirits and house wines
- Cold towels on deck all day
- Jugged coffee, tea and tisanes on deck from sunrise till sunset
- Shipboard staff gratuities are included in your cruise program price

THINGS WE CHARGE FOR

- Espresso and cappuccino bar
- Spa service including foot, head and body massages (Mekong only)
- Personal laundry service
- Premium or select wines from the Pandaw Wine List, and imported mineral waters

DINING ONBOARD

- All meals are single seating
- Table service is complimented with fresh salads, fruits and deserts (at lunch) on our buffet
- Attire is smart casual
- Breakfast and lunch is open-air
- Dinners are candlelit and comfortably air-conditioned
- At least two theme dinners, in addition to our Farewell Gala Dinner are provided

SPECIAL TO YOUR STATEROOM

- Fruit and flowers on arrival
- Kimonos and slippers
- Gilchrist & Soames or equivalent Spa-branded amenities
- Unlimited mineral water
- Free use of mini DVD player on request and selection of DVDs from our library (Based on availability)

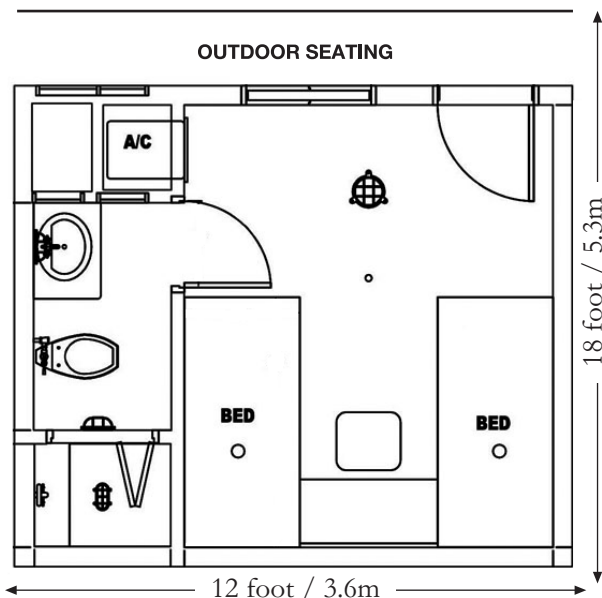

PANDAW CABIN PLAN

- Spare blankets or light duvet
- Optional choice of aromatherapy scents
- Mini safes and hair driers
- American adaptors for the European twin pin 230volt power supply
- Complimentary shoe cleaning service
- All rooms are no smoking
- All rooms are cleaned with microfibre cloths

GOING ASHORE

- All scheduled excursions accompanied by members of the crew with first aid kits, water, hand sanitizers and cold towels
- Entrance fees for sights included in the itinerary
- Comprehensive fact sheets or 'trip books' provided
- Visit Pandaw Charity projects along the way and interact with the local communities who welcome us
- Opportunity to travel to local markets with the Pandaw Chef at least once during the cruise program
- Crew assists in areas where river banks are steep and slippery
- Individual excursions welcomed, but please rejoin the ship on time

BEFORE AND AFTER YOUR CRUISE

- Transfers to and from the ship and a designated rendezvous point as per your itinerary
- You will need to arrange a visa before travelling for Myanmar and Vietnam. Insure that visa's are issued to reflect arrival 3 days prior to your actual date of arrival. Malaysia and Cambodia allow visa on arrival for most nationalities
- You need to check with your doctor that you are fit to travel and are up-to-date with all necessary prophylactics for the regions you will be travelling in
- You will need travel insurance to cover medical emergencies and loss of any personal possessions

TECHNICAL AND SAFETY

- Water purification and sewage treatment plants
- All ships have emergency generators
- Solas compliant life saving and emergency equipment including smoke and fire detectors
- Strict emergency training and drills for the crew
- Public and Indemnity insurance from London provided by Pandaw River Cruises
- Emergency VHF or satellite communications

RIVER CONDITIONS WARNING!

The rivers you will sail on are subject to seasonal rises and falls of water level, in some places as much as 30 metres. Water levels can change dramatically overnight and a sudden rise can impede our progress upstream considerably and even prevent us from passing under certain bridges. A sudden fall can result in our being unable to get into certain places or go as far upstream as we would hope. Groundings on sandbars are not infrequent and are part of the excitement of any Pandaw expedition. Published itineraries are indicational only and subject to sudden change. In such events alternative itineraries will be provided and we do our best to ensure that if a stop is missed we make up for it with another stop. Passengers are thus forewarned and expected to be flexible and patient. River cruising in Asia can be a dramatic and adventurous experience - not like cruising the controlled waterways of Europe or America. Note also that we operate in areas with little or no developed infrastructure and subject to the strictures of local officialdom. Be prepared for this and it is all more the fun!

ALL PANDAW SHIPS HAVE:

- Ultra shallow draft design averaging 1 meter
- Same main and upper deck stateroom size of 200 square feet / 20 sq meters
- English is the official language onboard
- Experienced Asian Purser with a minimum shipboard staff of 25
- Cocktail bar and dining room
- Observation or sun deck
- Gym equipment
- Ship's Office
- Library
- Shop
- Onboard Laundry
- Spa with head and feet massage and a range of other treatments

PANDAW AS A SOCIAL ENTERPRISE

- As a company we donate a portion of any annual surplus to support the projects of the Pandaw Charity
- For each passenger who completes our online survey after a cruise we donate US\$25 to the Pandaw Charity
- We support a number of NGO programmes that help local people train in tourism including the Cyclo tours in Phnom Penh and offering internships to students from NGO run hotel schools in Vietnam and Cambodia
- In Burma our passengers have built over 10 schools, 2 medical centres and support the Pandaw Hospital Ship that is still working in the Irrawaddy Delta in the aftermath of Cyclone Nargis
- In Cambodia we support an orphanage
- In Borneo we support a number of wildlife conservation projects and an orangutan sanctuary
- We source as much produce locally as we can to support local economies
- Pandaw ships with a self contained infrastructure have a low impact on the environment and do not disturb the often ecologically fragile areas we stop at
- Learn more on www.pandawcharity.com

MORE INFORMATION

You can order our brochure or the *Pandaw Magazine* when registering with us on http://www.pandaw.com/brochure_request.php and you can opt to subscribe to latest updates and offers by e-newsletter.

HOW TO BOOK

You can book via your travel agent or online with www.pandaw.com

America Toll Free: 800 798 4223

UK +44 (0)131 208 0017



Pandaw River Cruises

RV MEKONG PANDAW



ELEVATION

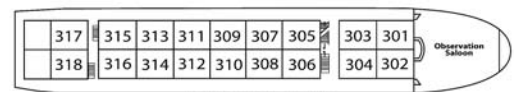

UPPER DECK



MAIN DECK

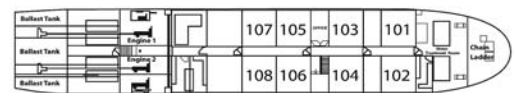

LOWER DECK

Built Rangoon 2003

Length 55 meters with 12 meter beam

26 Promenade Staterooms on Upper and Main Decks

Further eight suites on the lower deck

RV ORIENT PANDAW

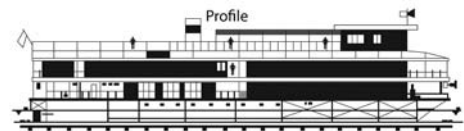

Profile

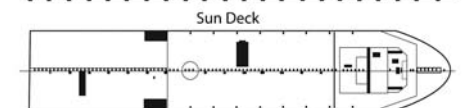

Sun Deck

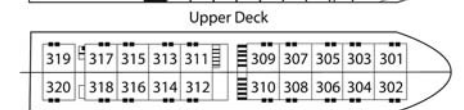

Upper Deck

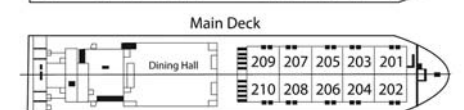

Main Deck



Lower Deck

Built Saigon 2008

Length 50 meters with 11 meter beam

30 Promenade Staterooms on Upper and Main Decks

Note: Upper deck staterooms 301 and 302 have a connecting door and may be booked together to form a suite

This vessel has a lounge cum lecture theatre on the lower deck

PANDAW II



ELEVATION

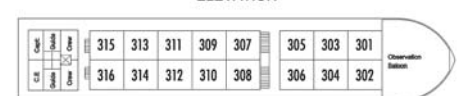

UPPER DECK



MAIN DECK

Built Rangoon 2001

Length 45 meters with 11 meter beam

24 Promenade Staterooms on Upper and Main Decks



Pandaw River Cruises

www.pandaw.com